

# Property Exhibit

of

## A Proposed Lot Line Adjustment

located in the Southeast 1/4 of Section 10, Town 4 North, Range 18 East, Town of East Troy, Walworth County, Wisconsin.

### Proposed Lot Line Adjustment From Tax Parcel PET 1000008 to Tax Parcel PSP 00012,

A parcel of land located in the Southeast 1/4 of Section 10, Town 4 North, Range 18 East, Town of East Troy, Walworth County, Wisconsin, described as follows: Commencing at an iron pipe marking the Northeast corner of Lot 16 of Spleas Subdivision; thence North 40°00'31" West, on the extension of the Northeastly line of said Lot 16, 8.40 feet to an iron pipe on the centerline of the 16.5' roadway discontinued by Resolution No. 90-14 of the Town of East Troy, dated November 12, 1990, as recorded in Vol. 548 on Page 292 as Document No. 224466, and the Point of Beginning; thence South 38°55'00" West, along said centerline, 18.42 feet to an iron pipe on the Easterly line of lands conveyed to the State of Wisconsin, Department of Transportation, Division of Highways by deed recorded March 4, 1969 in Volume 4 of Records on page 353, as Document No. 611392; thence North 18°41'40" West, along said Easterly line, 16.11 feet to an iron pipe; thence South 86°50'54" East 16.76 feet to the Point of Beginning. Said parcel contains 0.003 acres (125 sq. ft.) of land, more or less.

Copyright 2013 by Jensen & Olson Land Surveying, LLC.

All rights reserved. No part of this survey plat may be reproduced or transmitted in any form by any means - graphic, electronic, or mechanical, including photocopying, tracing, or information storage and retrieval systems - without permission in writing from Douglas G. Olson, Jensen & Olson Land Surveying, LLC.

I, Douglas G. Olson, Wisconsin Registered Land Surveyor, do hereby certify that this survey was performed by me, or under my direction in full compliance with the owner's/agent's instructions and Chapter A-E 7 of the Wisconsin Administrative Code "Minimum Standards for Property Surveys"; and that this map is an accurate representation thereof to the best of my knowledge and belief.

Douglas G. Olson  
Wisconsin Registered Land Surveyor - 2093

Surveyed for:

**Carol Cole**  
W1061 Spleas Skoney Road  
East Troy, Wisconsin. 53120

#### Notes:

- 1) This Property Exhibit is not an original unless signed and sealed in red ink.
- 2) This exhibit is subject to Wisconsin lien laws. This Property Exhibit is the notice of intent to file lien. Lien waiver required.

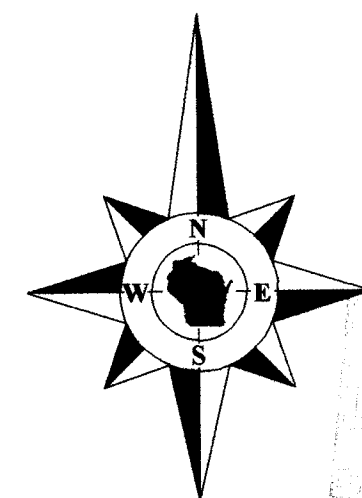
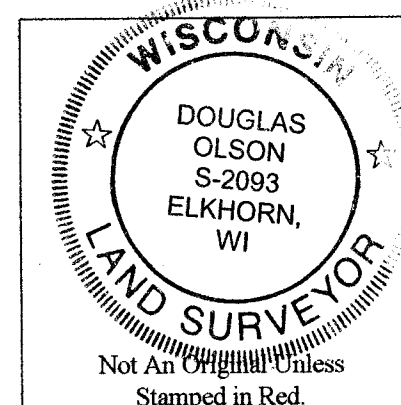

Bearings reference to the plat of Spleas Subdivision.

This lot line adjustment is for the purpose of a sale or exchange of land between adjoining land owners that does not create additional lots and the original parcels are not reduced below the minimum size required by the Walworth County Code of Ordinances (Zoning/Shoreland Zoning).

Survey Date: October 11, 2013.  
Revisions:

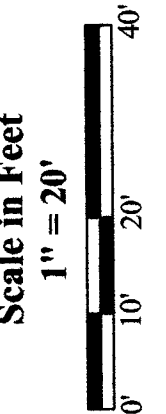

**Jensen & Olson Land Surveying, LLC**

45 South Wisconsin Street \* P.O. Box 322 \* Elkhorn, Wisconsin. 53121  
Telephone: (262) 723-3434 \* Facsimile: (262) 723-8044  
Email: jensen.olson@elknet.net

**Legend**  
 ■ Found Concrete Monument  
 ● Found Iron Pipe  
 ○ Found Iron Rod  
 ○ Found Iron Pipe, 1" dia.  
 ○ Recorded Information  
 ✕ Utility Pole  
 ◇ Septic Vent  
 ▨ Asphalt Surface  
 ▨ Concrete Surface  
 ▨ Gravel

Sheet 1 of 1 Sheets

Job Reference Number  
**2013.095**

2013.095

P ET10-8  
PSP-13  
PSP-12

418-2386